

UNPACKING INSTRUCTIONS

- ▲ Carefully open the carton, remove contents and lay out on cardboard or other protective surface to avoid damage.
- ▲ Check package contents against the Supplied Parts List in the next page to assure that all components were received undamaged. Do not use damaged or defective parts.
- ▲ Carefully read all instructions before attempting installation.

IMPORTANT SAFETY INFORMATION

- ▲ Install and operate this device with care. Please read this instruction before installation, and carefully follow all instructions contained herein. Use proper safety equipment during installation.
- ▲ Please call a qualified installation contractor for help if you don't understand these directions or have any doubts about the safety of the installation.

Do not use this product for any purpose or in any configuration not explicitly specified in this instruction. We hereby disclaims any and all liability for injury or damage arising from incorrect assembly, incorrect mounting, or incorrect use of this product.

Supplied Parts List

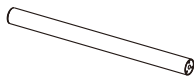

Pole
a (x1)

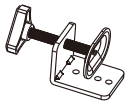

“C” Clamp
b (x1)

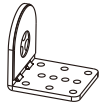

“C” Clamp Brace
c (x1)

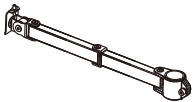

Swivel Arms
d (x2)

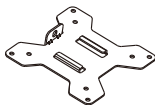

VESA Plate
e (x2)

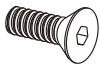

M5x14 Bolt
f (x3)

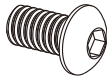

M8x12 Bolt
g (x2)



Nut
h (x2)



Grommet Base Plate
m (x1)



Wire Clip
n1 (x1)

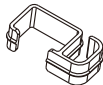

Wire Clip
n2 (x4)

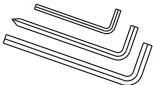

Allen Key
o (x1)



M4x10 Bolt
q (x8)



M4x30 Bolt
r (x8)



M4 Spacer
s (x8)

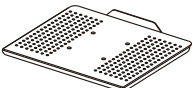

Laptop Tray
t (x1)



M4x10 Bolt
u (x4)



M4 Nut
v (x4)

Not Included	Phillips Screwdriver
--------------	----------------------

Step 1 Install the Pole to the Desktop

Option A: Desk Clamp Assembly

1. Use 3 pieces M5x14 bolts(f) to install the C Clamp brace(c) to the Pole. Use the Allen Key(o) to tighten the bolts. See Figure 1.

2. According to the thickness of the desktop, Use 2 pieces M8x12 bolts(g) to install the C clamp(b) to C clamp brace (c). Use Allen Key(o) to tighten the bolts and then tighten the C clamp to the desktop by adjusting the plastic knob. See Figure 2.

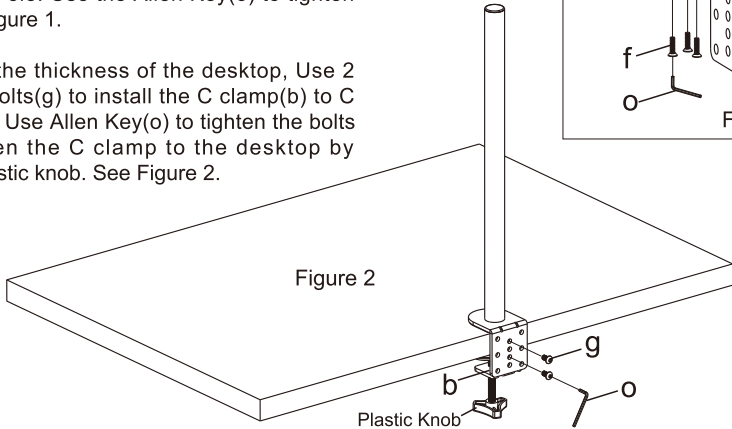
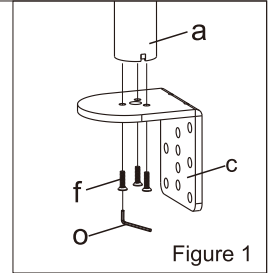

Option B: Grommet Base Install

Existing Grommet Hole Installation

If the existing grommet hole comes with a plastic protector, remove it to ensure a flat surface before installing the desk mount.

1. Loosen the screws, separate the "C"-Clamp(b) into two part. see Figure 4.

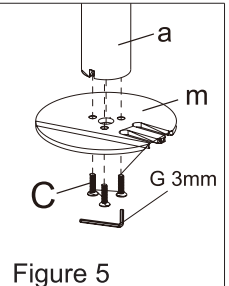
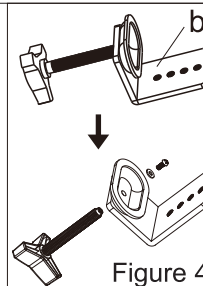

2. Install the Grommet Base Plate(f) to the Pole(a) using 3pcs M5x14 Bolts(C), and tighten using the Allen Key(O 3mm), see Figure 5.

3. Using the bolt (shown in Figure 4) through the support plate (b) and grommet hole in desktop. see Figure 6.

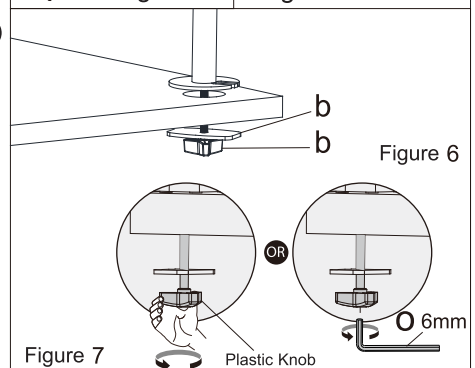

4. Tighten the Support Plate(b) to the desktop using the plastic knob or Allen Key(O 6mm). see Figure 7.

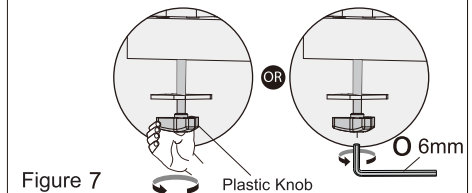

Step 2 Install Arm to the Pole

Install Swivel Arms(d) to the Pole(a). Fasten the bolt with supplied Allen Key(o). Attach the Wire Clip(n1,n2) to the Pole(a) and Swivel Arms(d).

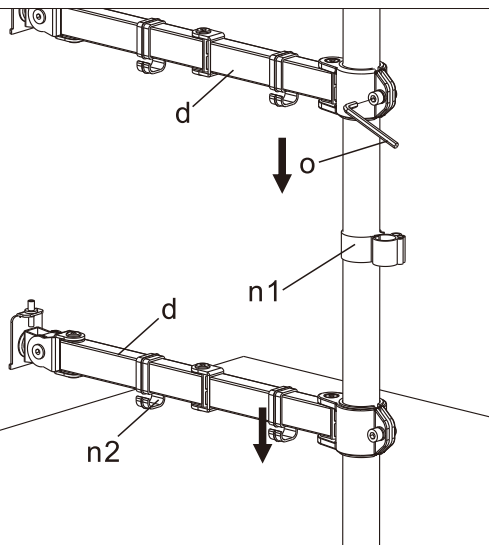

Step 3 Attach the VESA Plate to the Laptop Tray or Monitor

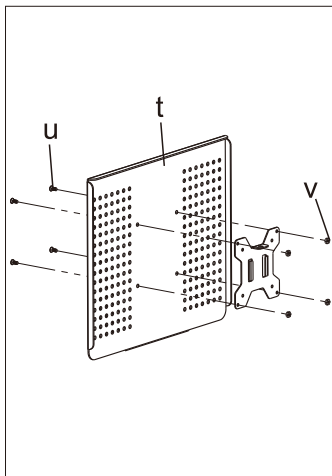

For Laptop

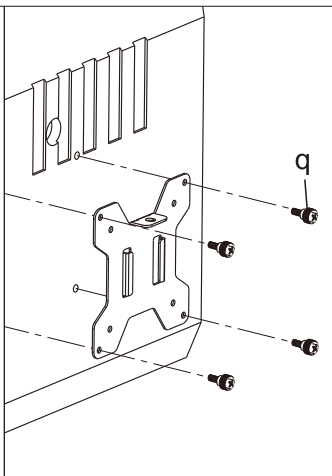

For Monitor with Flat Back

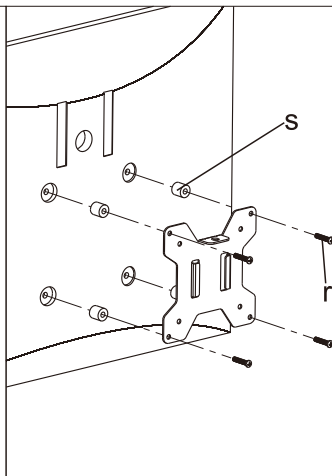

For Monitor with Curved
or Recessed Back

Step 4

Slide the Monitor onto the Head of Swivel Arm

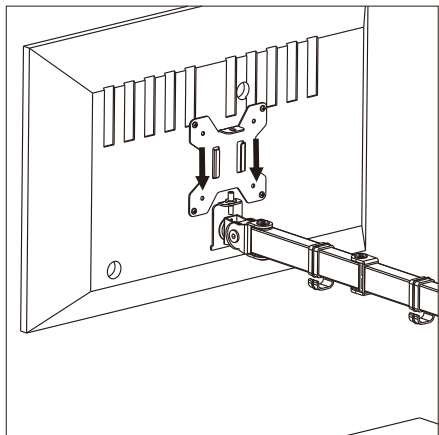

Slide the monitor onto the head of Swivel Arm(d) as shown in the above diagram.

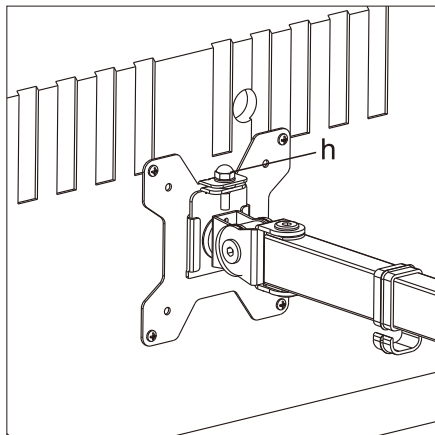

Install the security Nut(h). Make sure the security nut is installed before you rotate the monitor.

Step 5

Make the Necessary Adjustments

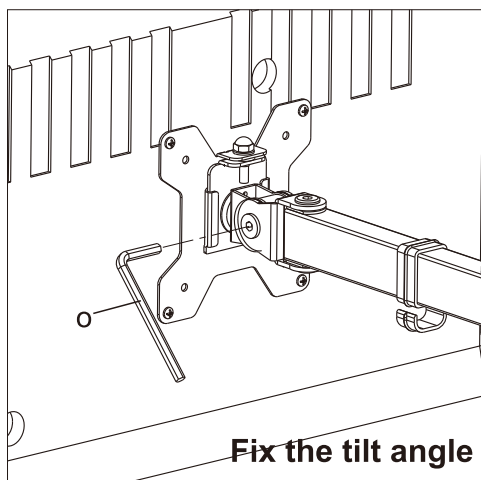

Fix the tilt angle

Tighten the bolt with the supplied Allen Key(o) to fix the tilt angle.

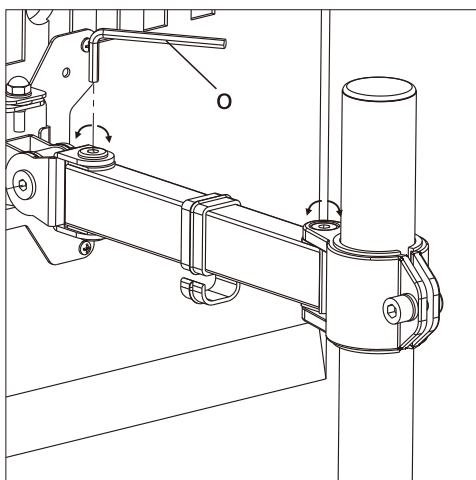

Use the supplied Allen Key(o) to make the necessary adjustments.

Step 6

Manage the Wires and Store the Allen Keys on Wire Clip

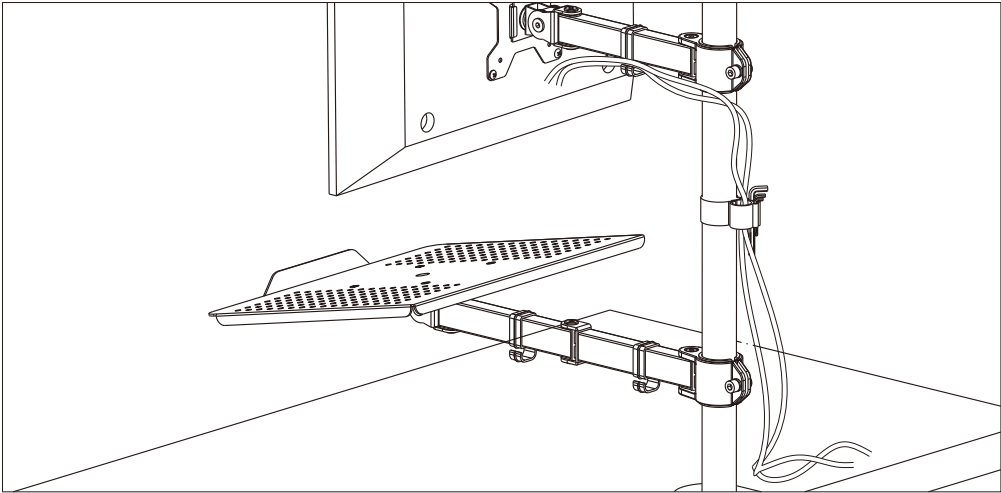

Step 7

All Done

