

# Monitor Desk Mount Instruction Manual

V4.0(A)

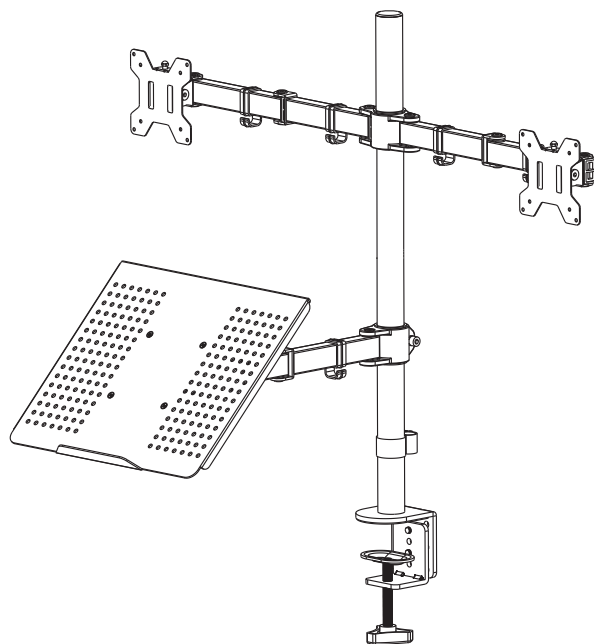

**MS-23**

## IMPORTANT SAFETY INSTRUCTIONS

- Please carefully read all instructions before attempting installation.
- CAUTION: Avoid potential personal injuries and property damage!
- Do not use this product for any purpose that is not explicitly specified in this manual. Do not exceed weight capacity. We are not liable for damage or injury caused by incorrect assembly or inappropriate use.
  - The desk must be capable of supporting five times the weight of the monitor and mount combined.

## Check the VESA Pattern of Your Monitor before the Installation

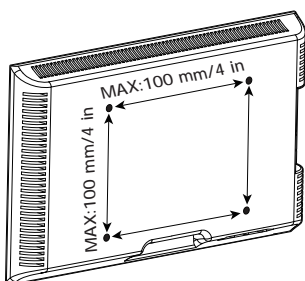

75 mm  $\approx$  3 in  
100 mm  $\approx$  4 in

Minimum VESA pattern:  
75mm/3 in (W)x75mm/3 in (H)

If your monitor VESA is greater than 100x100 mm/4x4 in or less than VESA 75x75mm/3x3in, this mount is NOT compatible.

## Weight Restrictions



If your monitor weighs more, this mount is NOT compatible.

### WARNING

DO NOT exceed the maximum weight indicated. This mounting system is intended for use only within the maximum weights indicated. Use with products heavier than the maximum weights indicated may result in failure of the mount and its accessories, causing possible damage and or injury.

## Tools Need (Not Included)



Phillips  
Screwdriver



Electric Drill  
(Optional)



7/16 in (11mm) – 55/64 in (22mm)  
Drill Bit(Optional)



3/8 in (10mm)  
Wrench

# Supplied Parts and Hardware

**⚠ Warning:** This product contains small items that could be a choking hazard if swallowed. Before starting assembly, verify all parts are included and undamaged. Do not use damaged or defective parts.

- Please note: Not all hardware included in this package will be used.

## Supplied Parts and Hardware for Step 1



Pole  
a (x2)



C Clamp Plate  
b (x1)



C Clamp Plate  
c (x1)



M5x16mm Bolt  
f (x3)



M8x12mm Bolt  
g (x2)



Locking Plate  
j (x1)



Grommet Plate  
m (x1)



Medium Allen Key  
o (x1)



Small Allen Key  
o (x1)

## Supplied Parts and Hardware for Step 2

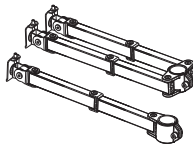

Swivel Arm  
d (x1)

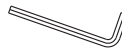

Large Allen Key  
o (x1)



Wire Clip  
n1 (x1)

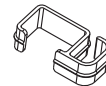

Wire Clip  
n2 (x6)

## Supplied Parts and Hardware for Step 3

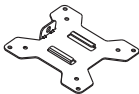

VESA Plate  
e (x3)



M4x12mm Thumb Bolt  
q (x8)



M4x30mm Bolt  
r (x8)



M4 Spacer  
s (x8)



M4x10mm Bolt  
u (x4)



M4 Nut  
v (x4)

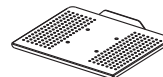

Laptop Tray  
t (x1)

# Supplied Hardware for Step 4



Nut  
h (x3)

# Supplied Hardware for Step 5



Medium Allen Key  
o (x1)

# Step 1 Install the Pole to the Desktop

## Option A: Desk Clamp Assembly

1A-1

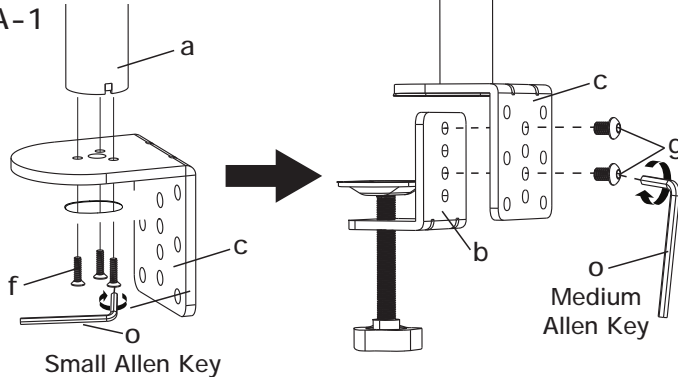

1A-2

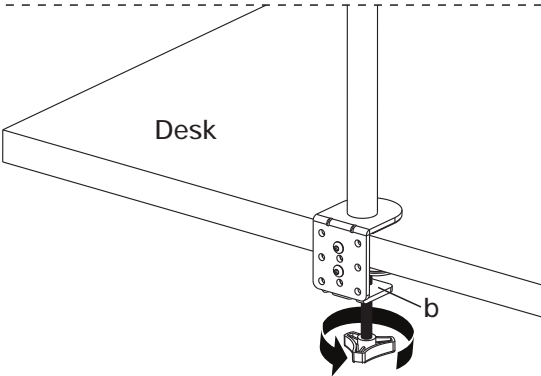
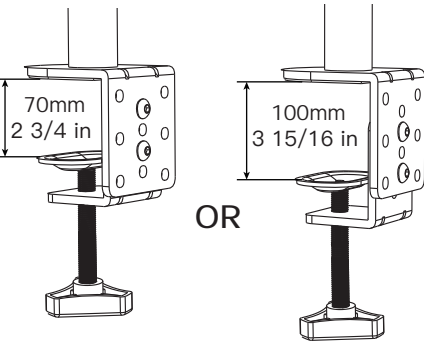

## Option B: Grommet Base Assembly



Phillips Screwdriver  
(Not Included)

### Note:

1. If the existing grommet hole comes with a plastic protector, remove it to ensure a flat surface before installing the desk mount.
2. If there is no grommet hole on your desk, mark the pilot hole on your desired position. Drill a hole using the drill bit in a diameter of 7/16 in (11mm) - 55/64 in (22mm) at the marked position through the mounting surface.

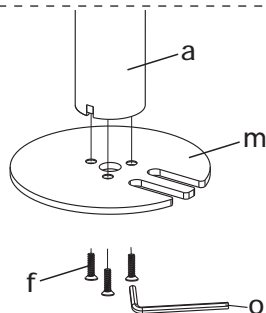

Small Allen Key

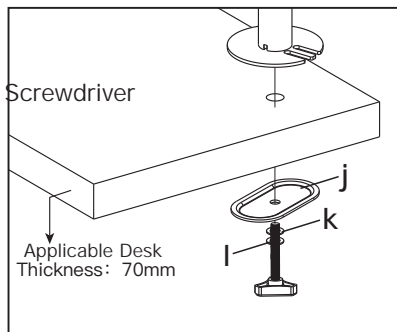
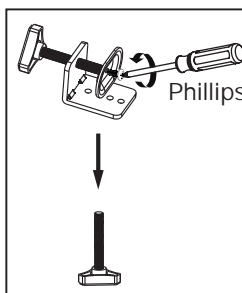

## Step 2 Install Swivel Arms to the Pole

Install swivel arms (d) to the pole (a). Fasten the bolt with supplied Allen key (o). Attach the wire clip (n1,n2) to the pole (a) and swivel arms (d).

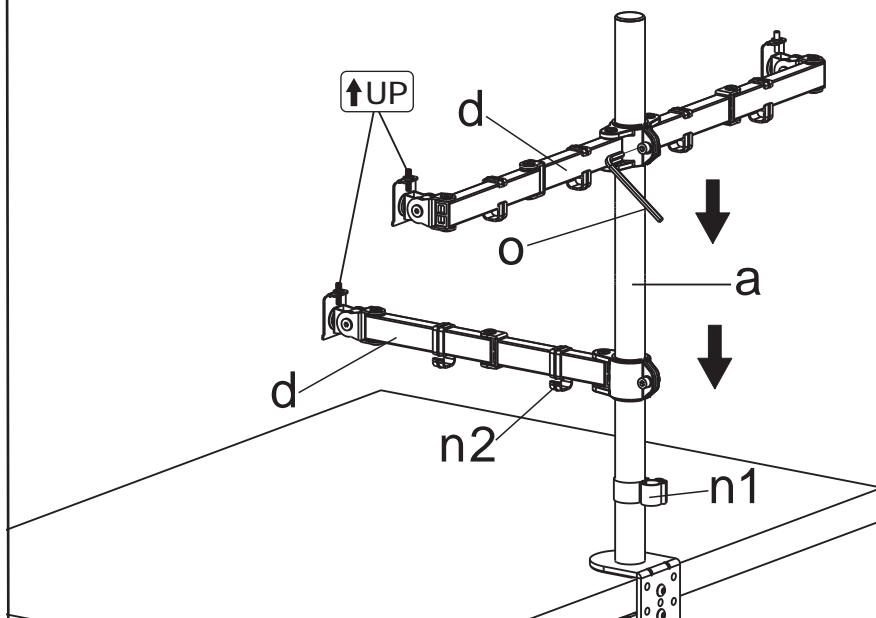

### Step 3 Attach the VESA Plate to the Laptop Tray or Monitor

For Monitor with Flat Back

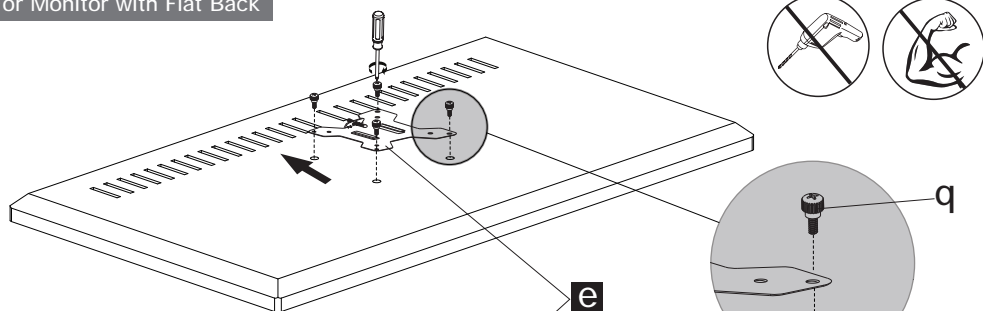

For Monitor with Curved or Recessed Back

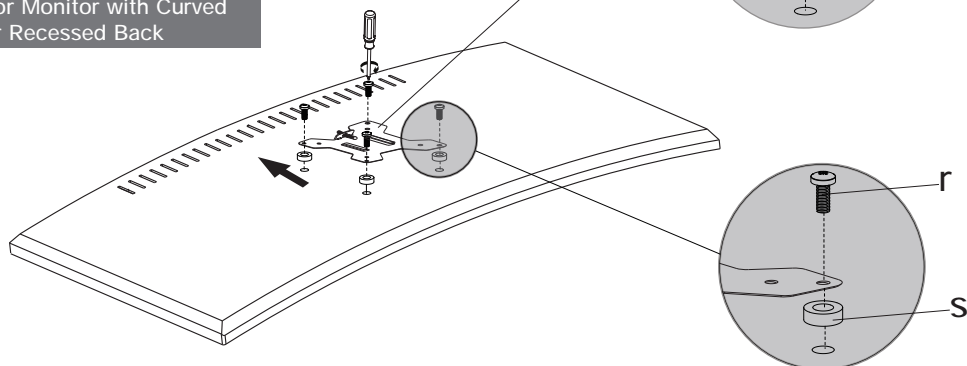

For Laptop

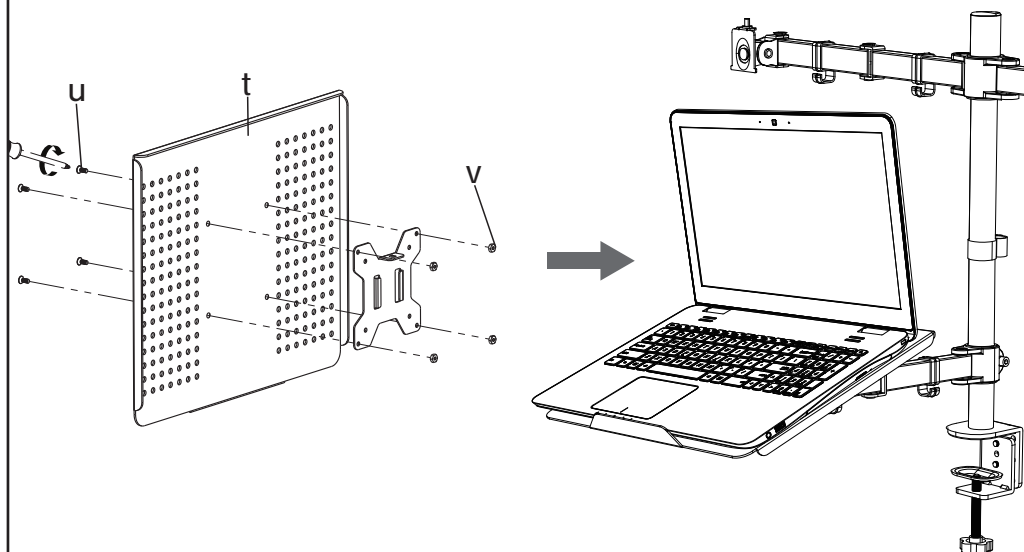

## Step 4 Secure the Monitor or Laptop Tray onto the Head of Swivel Arm



**HEAVY!** You may need assistance with this step.

Note: Please refer the procedures 4-1 and 4-2 to install the laptop tray [t] with VESA plate [e] onto the head of swivel arm



Wrench  
3/8 in. (10mm)  
(Not Included)

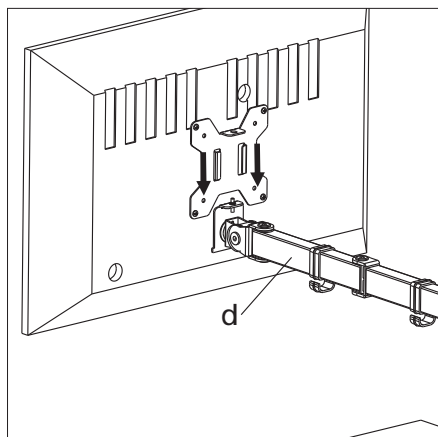

4-1 Slide the monitor onto the head of Swivel Arm (d) as shown in the above diagram.

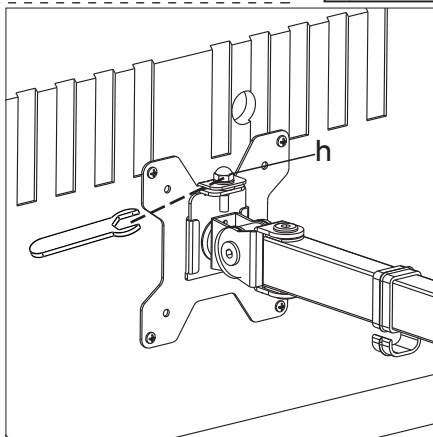

4-2 Secure the Nut (h). Make sure the nut is installed before you rotate the monitor.

## Step 5 Adjustment

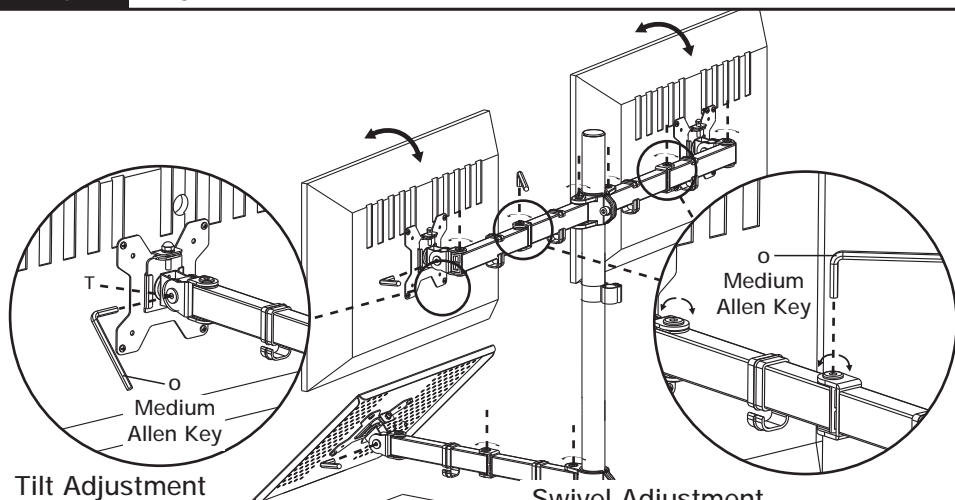

### Tilt Adjustment

1. Directly tilt your Monitor to your desired angle(if it is difficult to tilt the Monitor, for better to tilt monitor you can slightly loosen the nuts [T] using the Allen key).
2. Tighten the nuts [T] to hold the monitor in place.

### Swivel Adjustment

1. Directly swivel your monitor to your desired angle(if it is difficult to swivel the monitor, for better to tilt Monitor you can slightly loosen the nuts using the Allen key).
2. Tighten the nuts to hold the monitor in place.

## Slightly Adjust the Height of each Monitor

If the monitor is lower, remove the nut [h] and turn the bolt counter-clockwise with supplied Allen key [o] to raise the monitor. Install the nut [h] after the adjustment.

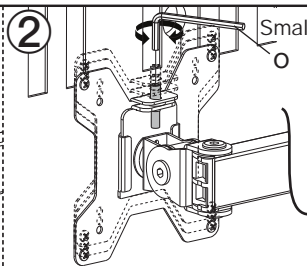
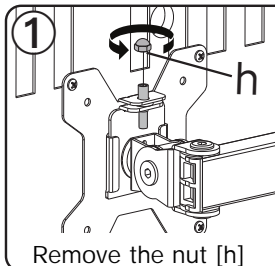

Small Allen Key

Use the Allen key [o] to slightly adjust the height of each monitor and re-tighten the nut [h] after finishing height adjustment. Individual monitor height adjustment helps monitors to be perfectly aligned.

## Step 6 Manage the Wires and Store the Allen Keys on Wire Clip

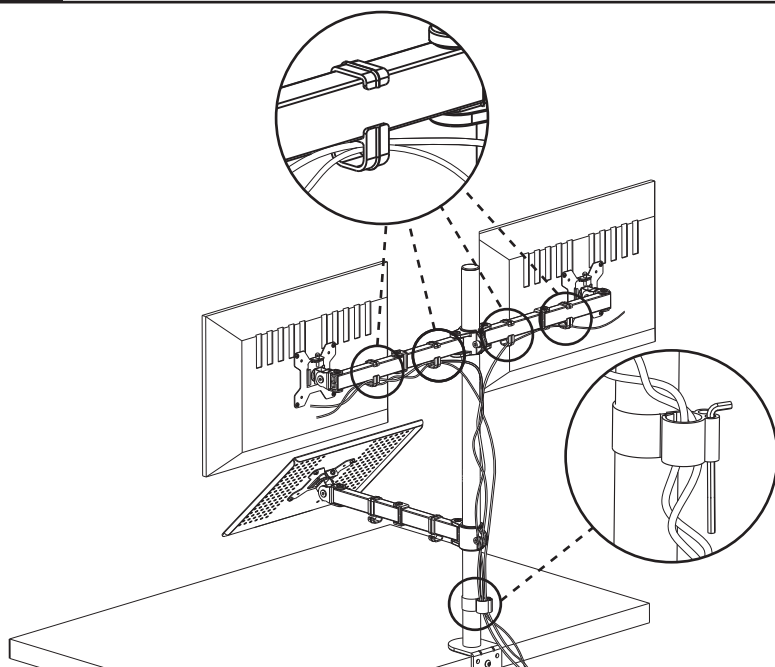

### Warning:

To avoid tipping, please be careful not to extend the arms too far forward or backward. When you adjust the angle of the arms, please make sure two arms are balanced to avoid instability of the center of gravity of the base.

